

Precision Rotary Stage with 5C Collet

FEATURES

- High Precision RTS-150 Rotary Stage
- Compatible with 5C Lathe Collets
- Integrated Pneumatic Actuation
- Ø 28.0mm through bore
- Low-Inertia Design
- Dead-Length Collet Closing



The RTS-150-5C is a high-precision rotary motion system with integrated 5C work holding. Designed specifically for large-tube laser processing, it offers excellent angular accuracy, runout, wobble, and smooth low-speed profiling. It's low-friction pneumatic drawbar design enables precise clamping force adjustment. For more specific details on the base stage, please see the datasheet for the RTS-DD-150-BB-(C/D/E)-A-S-0-00. Contact Griffin Motion for further details on the product, pricing or lead time.

RTS-150-5C Datasheet

Dimensions

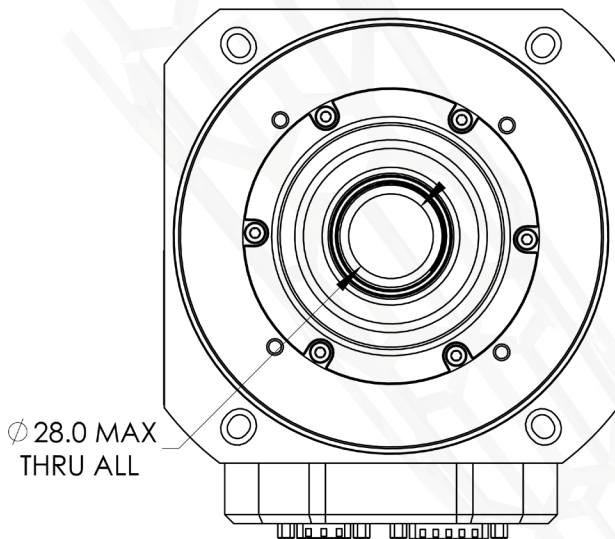

Specifications

Air Pressure Range (PSI)	60-90
Air Quality Required	ISO8573-1:2010 Class 3.4.3
Angular Accuracy +/- (arc-sec)	30
Angular Repeatability +/- (arc-sec)	4
Angular Velocity (deg/s)	1750
Collet Type	5C
Continuous Torque (Nm)	1.56
Peak Torque (Nm)	3.96
Piston Surface Area (mm ²)	2645
Radial Runout of Collet Bore (µm)	<30
Rotational Inertia (kg-m ²)	0.0033
Stage Mass (kg)	5.8
Through Bore (mm)	28.0

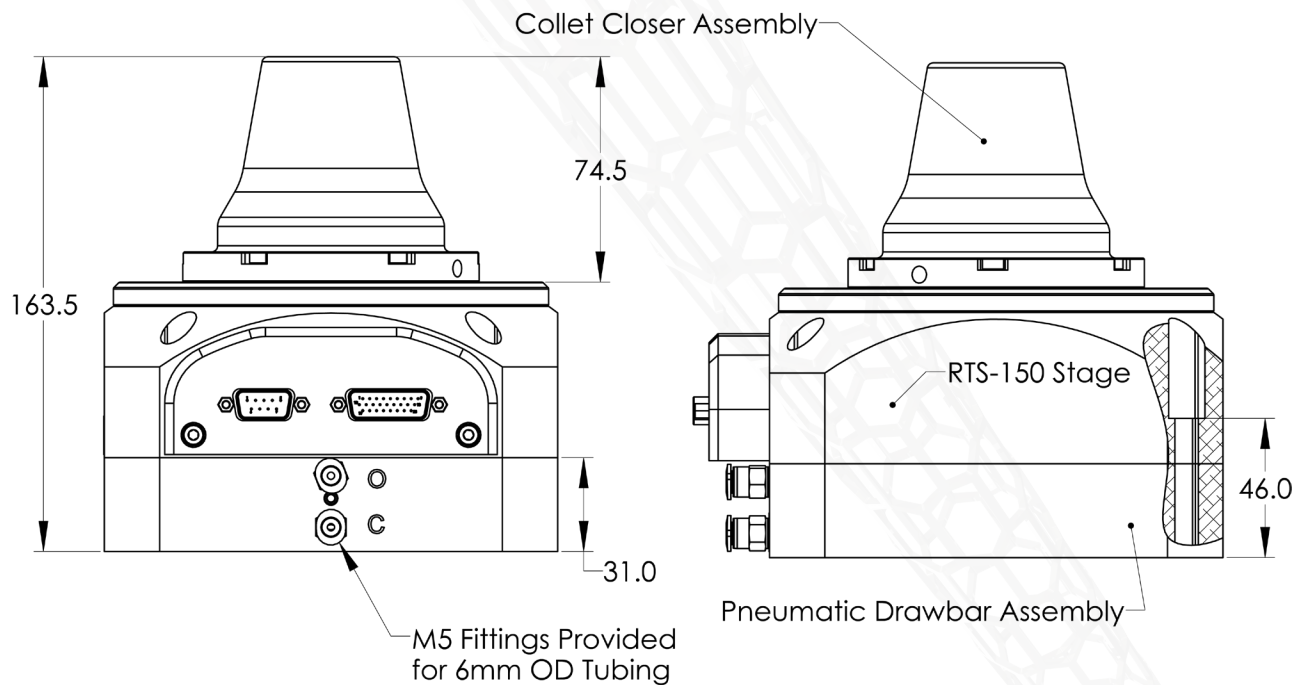

For more detailed stage dimensions, see the datasheet for the RTS-DD-150.